

Bike	Yamaha N-max	Part No.	RYA-104
Year	2015-Current	Fit Kits	Z039.10593
Notes	Where not supplied use original fittings Use original gasket to fit with Scorpion product. Yamaha part number 2DP E461300.	dB Killer	Z038.10540 (TYPE MM)

Estimated Fitting Time: 60 Minutes

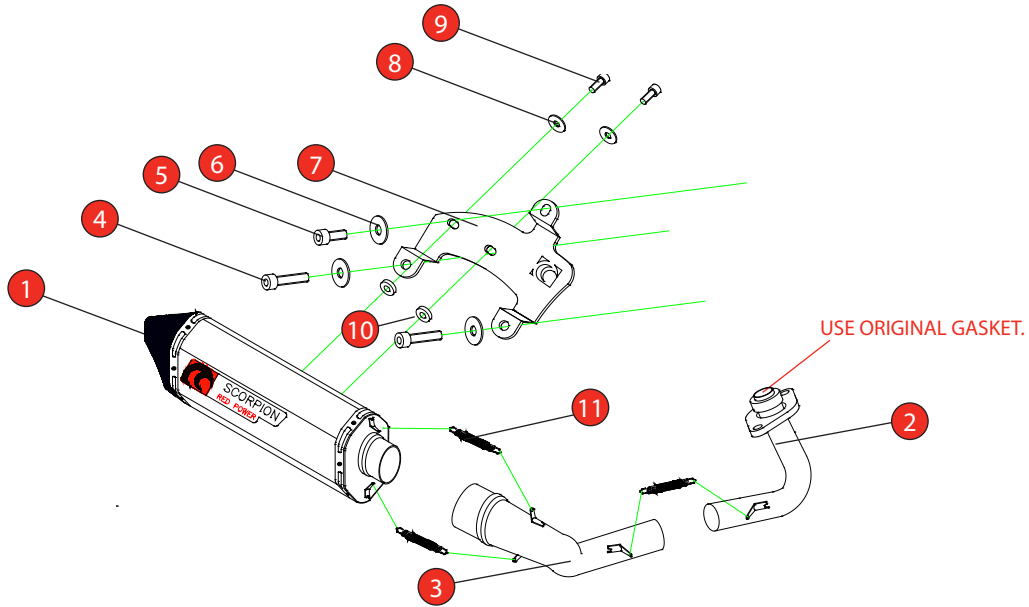

NO.	PART NO.	DESCRIPTION	QTY
1	RSC382	Serket Parallel Silencer	1
2	Z035.10921	Header Pipe	1
3	Z035.10922	Connecting Pipe	1
Fit Kit - Z039.10593			
4	Z017.12760	M10 x 35mm Fine Thread Cap Head Bolt	2
5	Z017.12765	M10 x 20mm Fine Thread Cap Head Bolt	1
6	Z017.10108	M10 x 20mm Washer	3
7	Z015.31299	Mounting Bracket	1
8	Z017.10825	M8 x 25mm Washer	2
9	Z017.10044	M8 x 20mm Hex Head Bolt	2
10	Z026.20049	M8 x 5mm Alloy Spacer	2
11	Z028.10030	Rubber Coated Spring	3

E-MARK	e11 00509
DATE	24/02/17
ISSUE	01
AUTHORISED	M.Ydlibi

NOTE: ENSURE SCORPION SYSTEM IS CLEAR OF MOVING PARTS AND ALL ORIGINAL FUNCTIONS WORK CORRECTLY.

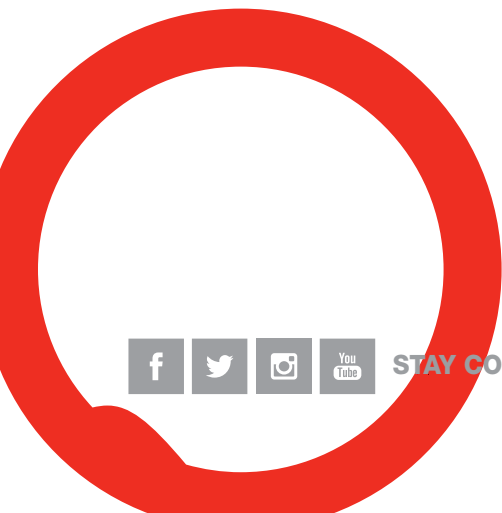

STAY CONNECTED TO RED POWER.

Car	Yamaha N-Max	Part No.	RYA-104
Year	2015-Current	Fit Kits	Z039.10593
Notes	Where not supplied use original fittings Use original gasket to fit with Scorpion product. Yamaha part number 2DP E461300.	dB Killer	Z038.10540 (TYPE MM)



A) Remove original exhaust from bike, taking care to keep all original components in a safe place.

B) Fit the header pipe using O.E Bolts finger tight, then slip on the connecting pipe.

C) Loosely fit the mounting bracket to the scooter.

D) Slide the silencer on to the connecting pipe.



E) Mount the silencer to the bracket ensuring you're using the correct bolts and spacers.

F) Once you're happy the silencer is fitted correctly, tighten all fittings.

G) Fit the springs to secure the fitting between the silencer and connecting pipe and the fitting between the connecting pipe between the header pipe.

H) When fitted, take scooter for a short test run, upon return allow bike to cool and check all nuts and bolts are secure.



Bike	Yamaha N-max	Part No.	RYA-104
Year	2015-Current	Fit Kits	Z039.10593
Notes	Where not supplied use original fittings Use original gasket to fit Scorpion product. Yamaha part number 2DP E461300	dB Killer	Z038.10540 (TYPE MM)

Estimated Fitting Time: 60 Minutes



Thank you for purchasing your Scorpion Silencer.

Care of your exhaust: Please refrain from cleaning silencer with heavy solvents or abrasives!

Vielen Dank Für den kauf eines Scorpion Schalldampfers! Pflegehinweis: Bitte verwenden Sie niemals Scheuermittel oder aggressive Reiniger zur Pflege Ihres Auspuffes!

Merci d'avoir choisi un echappement Scorpion.

Entretien de votre silencieux: Ne pas utiliser de solvants ou de produits abrasifs!

Muchas gracias por adquirir un Silencioso Scorpion. Le recomendamos no limpiar el silencioso con productos abrasivos o aquellos que contengan disolventes.



STAY CONNECTED TO RED POWER.